

SPECIFICATION



LOA		21.10 m	69' 3"
Hull length		20.50 m	67' 3"
LWL		19.20 m	63' 0"
Beam		5.90 m	19' 4"
Draft			
shallow keel		2.70 m	8' 10"
L-keel, medium		3.10 m	10' 2"
Displacement			
shallow keel	approx.	37.80 t	83,335 lbs
L-keel, medium	approx.	37.10 t	81,791 lbs
Engine Diesel			
standard	approx.	150 PS	150 hp
option	approx.	230 PS	230 hp
Fuel tank	approx.	1.100 l	291 gal
Fresh water	approx.	900 l	238 gal
CE Certificate		A - 12	
Design		judel / vrolijk & co	
Interior		HanseYachts Design	

Mast length above WL	approx.	31.95 m	104' 10"
Total sail area	approx.	246.70 m ²	2,655 sq ft
Main sail			
standard	approx.	146.80 m ²	1,580 sq ft
furling	approx.	132.63 m ²	1,428 sq ft
Self-tacking jib	approx.	99.90 m ²	1,075 sq ft
Reacher	approx.	168.98 m ²	1,819 sq ft
Gennaker	approx.	312.14 m ²	3,360 sq ft

675

All measurements/figures are approximate. Errors and omissions excepted. Specification and material can be changed without notice. Valid from 2022.03.29.

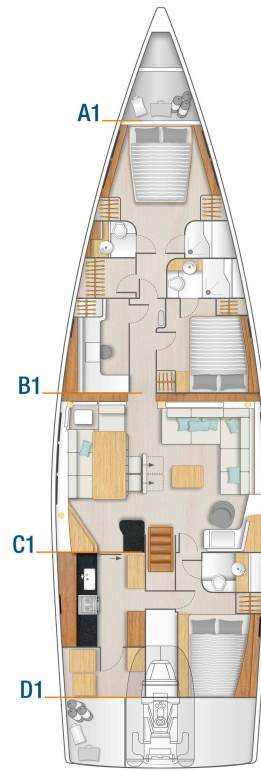

Standard

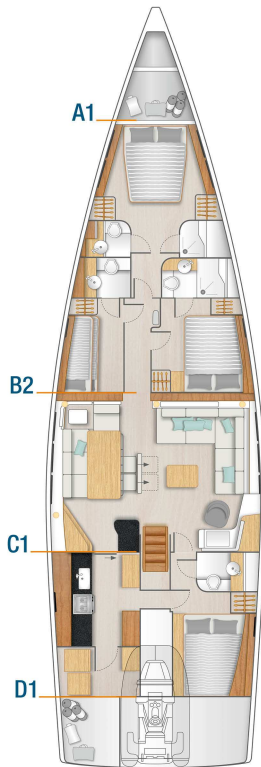

Option

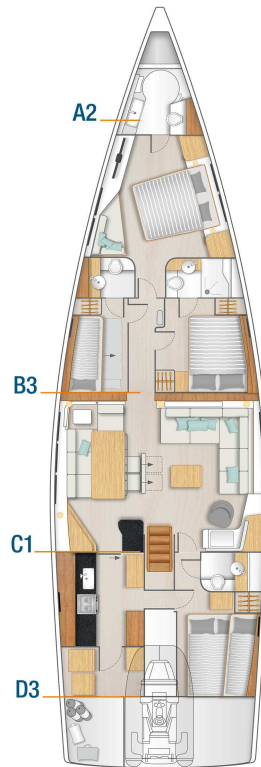

Option

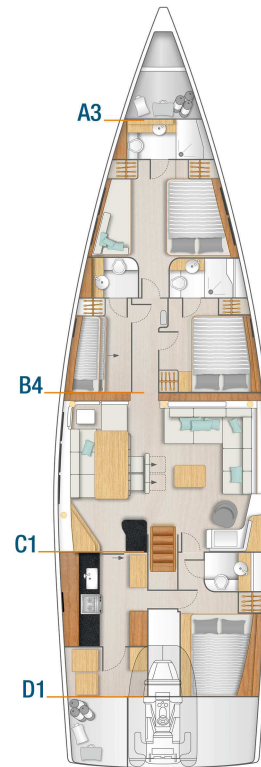

Option

HULL

- 14 hull windows (7 each side)
- GRP hull, isophthalic gelcoat, colour: Signal White (RAL9003), 1st layer vinyl ester resin and balsa sandwich laminat
- Waterline and cove line, isophthalic gelcoat, colour: Dark Grey (RAL 7043)

KEEL

- L-keel, cast iron, draft: 3.10 m

LAYOUT & INTERIOR

- A1: Sail locker in bow and master cabin with island berth, storage space and a separate head on port and shower stall on stb
- B1: VIP cabin with double berth, storage space and separate head with shower stall on stb and office and walk-in locker on port
- C1: Saloon with lounge area with L-sofa and large navigation area on stb and bar and dinning table on port
- D1: Full functional galley with utility room on port and double cabin with separate head on stb
- 3-burner gas stove with oven, ventilation hood, waste bin, 12 V fridge approx. 140 l, double stainless steel sink with mixing tab
- Interior furniture in high quality marine plywood, satin varnished
- Hanse companionway closing system
- Saloon table, fixed
- Worktop in galley - 'Marine Mineral Stone' Anthracite
- Courtesy lights in saloon
- Indirect lights in saloon and cabins, dimmable
- LED overhead lights in saloon and cabins, dimmable

WOOD (FURNITURE, FLOORBOARD)

- Furniture - Mahogany Style , Satin Varnish
- Cupboards fronts in wood colour
- Floorboard - Acacia
- Floorboard - wooden grating in all heads and showers

UPHOLSTERY

- Comfort mattresses for all berths
- Upholstery - Monte Carlo, colour: Cream

DECK & OUTSIDE EQUIPMENT

- GRP deck with antislip surface, isophthalic gelcoat, colour: Signal White (RAL 9003), 1st layer vinyl ester resin and balsa sandwich core. Cockpit locker on port and stb, stern locker, dinghy garage, stowage for running rigging at helm position, anchor locker at bow.
- Teak on cockpit bottom
- Teak on bathing platform
- 2 stainless steel steering wheels with leather cover
- 2 cockpit tables, stainless steel frame with teak top
- Pulpit and pushpit, stainless steel
- Railing, incl. stanchions and stainless steel wire with gateway stanchion
- Covered halyards and control lines lead to cockpit helmposition, organizers and jammers, 8 retractable mooring cleats, handrail on coachroof, bow anchor fitting with step
- 2 LEWMAR 65 EST EVO electrical halyard winches with automatic fuse
- 2 LEWMAR 65 ST EVO manual secondary winches
- Bathing platform, hydraulic fold-out, remote control and swimming ladder
- Courtesy lights in cockpit
- Helmsman footrests (extractable)
- Anchor windlass, electrical, 2000 W, with automatic fuse and remote control with chain counter
- Delta-anchor 45 kg, galvanized with 60 m galvanized chain
- Genoa tracks incl. cars with pin stop
- Self tacking jib system
- Mainsheet system
- 7 big and 6 small deck hatches - openable, anchor locker hatch, stowage on coachroof with acrylic glass hatch
- 10 deck coach roof windows - 4 openable on side, 1 openable as sliding roof, portlights in cockpit sides for aft cabins

RIG & SAILS

- Rig, anodized aluminium, keel stepped, with kicker, standing and running rigging and 2 reefs
- Backstay tensioner, hydraulic
- Vang, hydraulic
- Hydraulic jib furler

PROPULSION

- Fuel tank, approx. 1100 l
- Engine (Diesel, approx. 150 hp) - shaft drive, 3-blade folding propeller
- Bowthruster, 24V, 145 kp, retractable incl. batteries, electric

EQUIPMENT

- 24 V and 230 V electric system with digital switchboards, bus system, 230 V shore power and sockets in cabins and heads
- AGM battery set, capacity: 1x 90 Ah + 4x 225 Ah (450 Ah at 24 V)
- Country Version: EU / AUS
- Inverter/charger, 24 V / 7000 W - 200 A
- Manual toilet with sea water flush - cabin layout D1 and D3
- Electric toilet with sea water flush - cabin layout A1 - A3
- Manual toilet with sea water flush - cabin layout B1
- Manual toilet with sea water flush - cabin layout B2 - B4
- Shower unit in cockpit, warm-/ coldwater
- LPG gas system, 2 bottles in stowage
- Black water system (appr. 185 l, appr. 85 l for aft head) with deck extraction and seacock for head, electric and manual bilge pump
- Fresh water system with electric pump and 75 l hotwater, heated also by main engine
- Fresh water tank, appr. 900 l

ACCESSORIES

- Blind set with flyscreens for hatches, portlights and deck windows
- Blinds for hull windows in saloon and master cabin
- Blind for sunroof in saloon, electric
- Blinds for side coach roof windows
- LED Navigation lights, bow & stern
- Wind indicator
- Flagpole
- 8 fenders
- 8 mooring lines
- HANSE maintenance kit

SHIPPING & TRANSPORT

- CE - Certificate cat. A - 12
- Owners manual

- EC - Type Examination Certificate