

PRICELIST & SPECIFICATION



| | | | |
|----------------|----------------------|---------|------------|
| LOA | | 21.10 m | 69' 3" |
| Hull length | | 20.50 m | 67' 3" |
| LWL | | 19.20 m | 63' 0" |
| Beam | | 5.90 m | 19' 4" |
| Draft | | | |
| shallow keel | | 2.70 m | 8' 10" |
| L-keel, medium | | 3.10 m | 10' 2" |
| Displacement | | | |
| shallow keel | approx. | 37.80 t | 83,335 lbs |
| L-keel, medium | approx. | 37.10 t | 81,791 lbs |
| Engine Diesel | | | |
| standard | approx. | 150 PS | 150 hp |
| option | approx. | 230 PS | 230 hp |
| Fuel tank | approx. | 1.100 l | 291 gal |
| Fresh water | approx. | 900 l | 238 gal |
| CE Certificate | A - 12 | | |
| Design | judel / vrolijk & co | | |
| Interior | HanseYachts Design | | |

| | | | |
|----------------------|---------|-----------------------|-------------|
| Mast length above WL | approx. | 31.95 m | 104' 10" |
| Total sail area | approx. | 246.70 m ² | 2,655 sq ft |
| Main sail | | | |
| standard | approx. | 146.80 m ² | 1,580 sq ft |
| furling | approx. | 132.63 m ² | 1,428 sq ft |
| Self-tacking jib | approx. | 99.90 m ² | 1,075 sq ft |
| Reacher | approx. | 168.98 m ² | 1,819 sq ft |
| Gennaker | approx. | 312.14 m ² | 3,360 sq ft |

675

All measurements/figures are approximate. Errors and omissions excepted. Specification and material can be changed without notice. Valid from 2022.03.29.

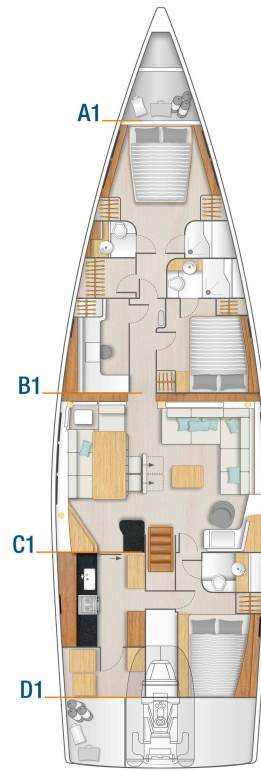

Standard

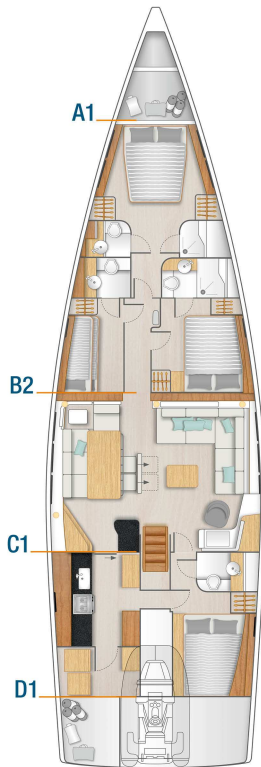

Option

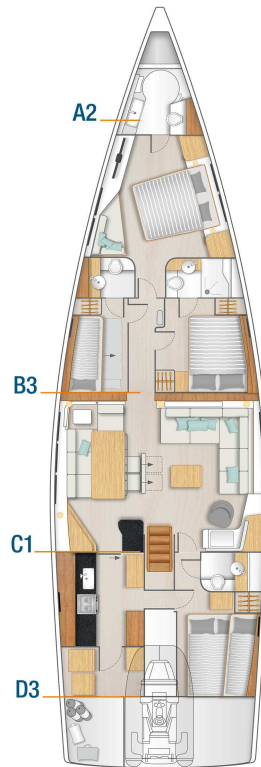

Option

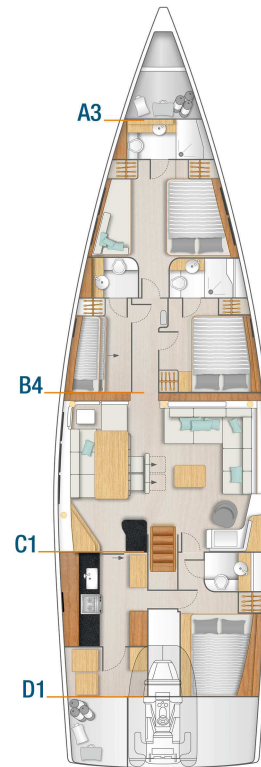

Option

HULL

- 14 hull windows (7 each side)
- GRP hull, isophthalic gelcoat, colour: Signal White (RAL9003), 1st layer vinyl ester resin and balsa sandwich laminat
- Waterline and cove line, isophthalic gelcoat, colour: Dark Grey (RAL 7043)

KEEL

- L-keel, cast iron, draft: 3.10 m

LAYOUT & INTERIOR

- A1: Sail locker in bow and master cabin with island berth, storage space and a separate head on port and shower stall on stb
- B1: VIP cabin with double berth, storage space and separate head with shower stall on stb and office and walk-in locker on port
- C1: Saloon with lounge area with L-sofa and large navigation area on stb and bar and dinning table on port
- D1: Full functional galley with utility room on port and double cabin with separate head on stb
- 3-burner gas stove with oven, ventilation hood, waste bin, 12 V fridge approx. 140 l, double stainless steel sink with mixing tab
- Interior furniture in high quality marine plywood, satin varnished
- Hanse companionway closing system
- Saloon table, fixed
- Worktop in galley - 'Marine Mineral Stone' Anthracite
- Courtesy lights in saloon
- Indirect lights in saloon and cabins, dimmable
- LED overhead lights in saloon and cabins, dimmable

WOOD (FURNITURE, FLOORBOARD)

- Furniture - Mahogany Style , Satin Varnish
- Cupboards fronts in wood colour
- Floorboard - Acacia
- Floorboard - wooden grating in all heads and showers

UPHOLSTERY

- Comfort mattresses for all berths
- Upholstery - Monte Carlo, colour: Cream

DECK & OUTSIDE EQUIPMENT

- GRP deck with antislip surface, isophthalic gelcoat, colour: Signal White (RAL 9003), 1st layer vinyl ester resin and balsa sandwich core. Cockpit locker on port and stb, stern locker, dinghy garage, stowage for running rigging at helm position, anchor locker at bow.
 - Teak on cockpit bottom
 - Teak on bathing platform
 - 2 stainless steel steering wheels with leather cover
 - 2 cockpit tables, stainless steel frame with teak top
 - Pulpit and pushpit, stainless steel
 - Railing, incl. stanchions and stainless steel wire with gateway stanchion
 - Covered halyards and control lines lead to cockpit helmposition, organizers and jammers, 8 retractable mooring cleats, handrail on coachroof, bow anchor fitting with step
 - 2 LEWMAR 65 EST EVO electrical halyard winches with automatic fuse
 - 2 LEWMAR 65 ST EVO manual secondary winches
 - Bathing platform, hydraulic fold-out, remote control and swimming ladder
 - Courtesy lights in cockpit
 - Helmsman footrests (extractable)
 - Anchor windlass, electrical, 2000 W, with automatic fuse and remote control with chain counter
 - Delta-anchor 45 kg, galvanized with 60 m galvanized chain
 - Genoa tracks incl. cars with pin stop
 - Self tacking jib system
 - Mainsheet system
 - 7 big and 6 small deck hatches - openable, anchor locker hatch, stowage on coachroof with acrylic glass hatch
 - 10 deck coach roof windows - 4 openable on side, 1 openable as sliding roof, portlights in cockpit sides for aft cabins
- ## RIG & SAILS
- Rig, anodized aluminium, keel stepped, with kicker, standing and running rigging and 2 reefs
 - Backstay tensioner, hydraulic
 - Vang, hydraulic
 - Hydraulic jib furler

PROPULSION

- Fuel tank, approx. 1100 l
- Engine (Diesel, approx. 150 hp) - shaft drive, 3-blade folding propeller
- Bowthruster, 24V, 145 kp, retractable incl. batteries, electric

EQUIPMENT

- 24 V and 230 V electric system with digital switchboards, bus system, 230 V shore power and sockets in cabins and heads
- AGM battery set, capacity: 1x 90 Ah + 4x 225 Ah (450 Ah at 24 V)
- Country Version: EU / AUS
- Inverter/charger, 24 V / 7000 W - 200 A
- Manual toilet with sea water flush - cabin layout D1 and D3
- Electric toilet with sea water flush - cabin layout A1 - A3
- Manual toilet with sea water flush - cabin layout B1
- Manual toilet with sea water flush - cabin layout B2 - B4
- Shower unit in cockpit, warm-/ coldwater
- LPG gas system, 2 bottles in stowage
- Black water system (appr. 185 l, appr. 85 l for aft head) with deck extraction and seacock for head, electric and manual bilge pump
- Fresh water system with electric pump and 75 l hotwater, heated also by main engine
- Fresh water tank, appr. 900 l

ACCESSORIES

- Blind set with flyscreens for hatches, portlights and deck windows
- Blinds for hull windows in saloon and master cabin
- Blind for sunroof in saloon, electric
- Blinds for side coach roof windows
- LED Navigation lights, bow & stern
- Wind indicator
- Flagpole
- 8 fenders
- 8 mooring lines
- HANSE maintenance kit

SHIPPING & TRANSPORT

- CE - Certificate cat. A - 12
- Owners manual

- EC - Type Examination Certificate

AS PER STANDARD SPECIFICATION

excl. VAT
1.591.900 €

PACKAGES

| | | |
|---------------|---|------------------|
| XW2010 | B&G Navigation Package (only with XK5000 or XK5010 for TV) | 35.890 € |
| XF2201 | 2 B&G H5000 multifunction displays on helmconsole, incl. transducer (wind/speed/depth/temperature) | |
| XF2223 | 2 B&G H5000 add. multifunction displays in cockpit | |
| XF3000 | B&G VHF V60 at chart table, incl. wireless remote handset H60 (only with XK5000 or XK5010) | |
| XF4000 | B&G Zeus ³ S Touch 16" Glass Helm chart plotter at chart table | |
| XF4011 | B&G Zeus ³ S Touch 19" Glass Helm chart plotter in cockpit | |
| XF4550 | MyHanse safety cloud with 24 months subscription and device installed on board | |
| XF4600 | B&G AIS Class B transponder | |
| XF5001 | B&G Autopilot with 2 H5000 control units and Precision 9 compass | |
| XF5200 | B&G CPU Hydra computer | |
| XF9001 | NMEA engine information interface for chart plotter | |
| XF9100 | GoFree wireless link | |
| <hr/> | | |
| XW2011 | Upgrade - 2 B&G 12" chart plotter at helm station, instead of B&G 19" chart plotter in cockpit | 1.290 € |
| XF4031 | 2 B&G Zeus ³ S 12" chart plotter, 1 per helm station | |
| <hr/> | | |
| XW4500 | Carbon Mast Package | 242.490 € |
| XE1002 | Rig, carbon, with rod rigging | |
| XE1070 | V-Boom, carbon | |
| XE9100 | Spreader lights, LED, 6 up and 6 down | |
| <hr/> | | |
| XW4501 | Upgrade - Carbon Furling V-Boom | 168.990 € |
| XE1071 | Furling V-Boom, carbon incl. furl finder (not with XE1001) | |
| <hr/> | | |
| XW7000 | Entertainment Package - Saloon and cockpit (only with XK5000 or XK5010 for TV) | 3.590 € |
| XH2090 | Wireless charging | |
| XK1000 | FUSION APOLLO MS-RA770 Multimedia radio with Wi-Fi and touchscreen - for saloon and cockpit | |
| XK2040 | 4 high-end 2-way speakers in saloon | |
| XK2070 | 2 high-end 2-way speakers in cockpit | |

- XK3070 FUSION MS-ERX400 remote control in cockpit
- XK5030 FUSION wireless link - remote control via mobile devices

XW7010 Entertainment Package - Master cabin (only with XK5000 or XK5010 for TV) 3.590 €

- XK1010 FUSION APOLLO MS-RA770 Multimedia radio with Wi-Fi and touchscreen - for master cabin
- XK2010 2 high-end 2-way speakers in master cabin

XW7015 TV Package - Master cabin (only with XW7030 or XK5010) 4.190 €

- XK1310 Blu-ray player in master cabin
- XK4010 TV preparation in master cabin
- XK4110 LED TV flat screen in fwd cabin
- XK4310 APPLE TV in master cabin

XW7030 TV Package - Saloon (only with XK5010) 5.590 €

- XK1340 Blu-ray player in saloon
- XK4040 TV preparation in saloon
- XK4140 LED TV flat screen in saloon
- XK4340 APPLE TV in saloon

OPTIONS

excl. VAT

HULL

- XA1001 GRP hull, gelcoat colour: Grey (RAL 7040) **10.290 €**
- XA1002 GRP hull, painted, non metallic (colour selection) **40.890 €**
- XA1003 GRP hull, painted, metallic (colour selection) **52.490 €**
- XA3001 Waterline and cove line, coloured gelcoat (colour selection - not with XA1002 or XA1003) **1.090 €**
- XA3002 Waterline and cove line, painted, non metallic (colour selection - only with XA1002 or XA1003) **1.090 €**
- XA3003 Waterline and cove line, painted, metallic (colour selection - only with XA1002 or XA1003) **3.690 €**

KEEL

- XB1001 L-keel, cast iron/lead, draft: 2.70 m **38.290 €**

LAYOUT & INTERIOR

- XL1002 A2: Master cabin with transversal island berth, storage space and generous head with separate shower stall in bow **10.290 €**

| | | |
|--------|---|-----------------|
| XL1003 | A3: Sail locker in bow and master cabin with double berth on stb, sofa on port and a separate head with shower stall | 7.990 € |
| XL2002 | B2: VIP cabin with double berth, storage space and separate head with shower stall on stb and cabin with double bunk bed and separate head on port | 7.590 € |
| XL2003 | B3: VIP cabin with double berth, storage space and separate head with shower stall on stb and cabin with retractable double berth and separate head on port | 9.790 € |
| XL2004 | B4: VIP cabin with double berth, storage space and separate head with shower stall on stb and cabin with bunk bed, retractable double berth and separate head on port | 10.290 € |
| XL4003 | D3: Full functional galley with utility room on port and cabin with bunk bed, double berth and retractable table and separate head on stb | 6.690 € |
| XL7001 | Saloon table electrically lowerable with cushions, convertible into double berth | 5.290 € |
| XL7601 | Worktop in galley - 'Marine Mineral Stone' Vanilla | 1.090 € |
| XL9030 | Acrylic insert with indirect lights in saloon | 3.390 € |

WOOD (FURNITURE, FLOORBOARD)

| | | |
|--------|---|-----------------|
| XM1102 | Furniture - Canadian Chestnut | 10.490 € |
| XM1103 | Furniture - Teak, satin varnish | 11.490 € |
| XM1104 | Furniture - French Oak | 10.490 € |
| XM1150 | Furniture - High gloss finish (only with XM1100 or XM1102) | 21.790 € |
| XM1161 | Cupboard fronts coloured (partial as per design - colour selection) | 5.690 € |
| XM1202 | Floorboard - Noce Nero | 1.590 € |
| XM1203 | Floorboard - Delight Oak | 1.590 € |

UPHOLSTERY

| | | |
|--------|--|----------------|
| XN1100 | Deluxe mattresses for all berths | 3.990 € |
| XN2001 | Upholstery - Sorrento (colour selection) | 3.290 € |
| XN2002 | Upholstery - Florence (colour selection) | 4.490 € |
| XN2003 | Upholstery - Monaco (colour selection) | 6.490 € |
| XN2004 | Upholstery - Portofino Leather (colour selection) | 9.890 € |
| XN2080 | 2 foldable directors chairs for saloon or cockpit | 2.290 € |
| XN2200 | Sun bed cushion on foredeck (colour selection) | 3.290 € |
| XN2201 | Comfort sun bed cushions on foredeck (colour selection) | 6.190 € |
| XN2500 | Cockpit cushions (colour selection) | 3.790 € |
| XN2501 | Comfort cockpit cushions (colour selection) | 7.290 € |
| XN3014 | Carpets in cabins and passage to forward cabins (colour selection) | 3.490 € |

| | | |
|--------|--|----------------|
| XN3020 | Paillason in saloon (colour selection) | 3.190 € |
|--------|--|----------------|

DECK & OUTSIDE EQUIPMENT

| | | |
|--------|---|-----------------|
| XC1300 | Teak on side deck | 28.890 € |
| XC1301 | Flexiteek on side deck (colour selection) | 33.590 € |
| XC1310 | Teak on coach roof | 15.290 € |
| XC1311 | Flexiteek on coach roof (colour selection) | 16.090 € |
| XC1321 | Flexiteek on cockpit bottom (colour selection) | 4.590 € |
| XC1333 | Teak on helmsman seats | 990 € |
| XC1334 | Flexiteek on helmsman seats (colour selection) | 1.090 € |
| XC1351 | Flexiteek on bathing platform (colour selection) | 790 € |
| XC2201 | 2 GRP steering wheels, Y-spoke (black or white) | 1.890 € |
| XC2202 | 2 GRP steering wheels, Y-spoke, carbon clear coated | 6.290 € |
| XC3004 | 2 cockpit tables, stainless steel with teak tops and handrail, electrically lowerable into sunbed incl. upholstery | 5.790 € |
| XC5105 | 2 LEWMAR 80 EST EVO electrical halyard winches with automatic fuse (only with XH1001 or XH1005) | 23.690 € |
| XC5202 | 2 LEWMAR 65 EST EVO electrical secondary winches with automatic fuse (only with XH1001 or XH1005) | 10.990 € |
| XC5205 | 2 LEWMAR 80 EST EVO electrical secondary winches with automatic fuse (only with XH1001 or XH1005) | 23.690 € |
| XC6501 | Gangway, carbon, foldable with bag, 220 cm | 3.590 € |
| XC6502 | Gangway, retractable, electric/hydraulic with remote control | 27.590 € |
| XC6601 | Stainless steel ladder for gateway exit, foldable | 1.190 € |
| XC7001 | Easy Tender System with windlass and launching system | 11.490 € |
| XC7100 | Air compressor for tender | 890 € |
| XC9020 | Rub rail, teak | 5.690 € |
| XC9021 | Additional stainless steel rail (only with XC9020) | 3.390 € |
| XC9040 | LED lights for side decks, integrated in toerail, white | 4.190 € |
| XC9041 | 6 underwater multicolour lights (red, green, blue and white) below transom | 6.890 € |
| XC9051 | Electrical deck wash pump, mounted in bow area with outlet on deck | 1.190 € |
| XC9060 | 2 helmsman seats, foldable on stb (only with XC1333 or XC1334) | 2.690 € |
| XC9081 | 4 enlarged cleats - bow and stern and 4 standard size cleats - midship (2 each side) | 9.490 € |
| XC9088 | Combined mooring/anchor windlass, 2000W, electrical, with automatic fuse, incl. chain counter and remote control (only with XH1001 or XH1005) | 3.190 € |
| XC9089 | Combined mooring/anchor windlass, 3000W, electrical, with automatic fuse, incl. chain counter and remote control (only with XH1001 or XH1005) | 4.590 € |
| XC9101 | Delta-anchor 45 kg, stainless steel, with 'Power Ball' swivel and 100 m stainless steel chain | 7.990 € |

RIG & SAILS

| | | |
|--------|--|-----------|
| XE1001 | Rig, anodized aluminium with hydraulic inmast furling system | 31.490 € |
| XE1004 | Rig, anodized aluminium, painted (only with XE9002) | 21.490 € |
| XE1071 | Furling V-Boom, carbon incl. furl finder (not with XE1001) | 180.090 € |
| XE1221 | Second forestay with second furler, hydraulic | 19.490 € |
| XE2001 | Lazy bag with lazy jacks (colour selection - not with XE1001, XE1071) | 2.790 € |
| XE2009 | Canvas windscreen with stainless steel stake (colour selection - not with XE2010) | 4.390 € |
| XE2010 | Fixed windscreen with stainless steel frame (not with XE2012) | 8.090 € |
| XE2012 | Sprayhood with stainless steel stake, 3 windows (1 openable - colour selection - not with XE2009, XE2010, XE2051, XE2052 and XE2053) | 4.390 € |
| XE2013 | Cockpit canvas cover for GRP hardtop - side and front (colour selection - only with XE2051/XE2052/XE2053 and XE2009 or XE2010) | 4.590 € |
| XE2021 | Bimini top with stainless steel stake (colour selection - not with XE2049, XE2051, XE2052 or XE2053) | 9.090 € |
| XE2049 | GRP arch for cockpit - white | 14.990 € |
| XE2051 | GRP hard top for cockpit with canvas sliding roof - white | 28.790 € |
| XE2052 | GRP hard top for cockpit with canvas sliding roof - outside surface painted, non metallic (colour selection) | 34.490 € |
| XE2053 | GRP hard top for cockpit with canvas sliding roof - outside surface painted, metallic (colour selection) | 37.990 € |
| XE3010 | QUANTUM TP6 high - performance sails, full battened, UV protected membrane, main and jib | 69.290 € |
| XE3024 | QUANTUM TP6 high - performance sail - for second forestay, UV - protected membrane, Reacher 140% (only with XE1221) | 40.890 € |
| XE3105 | QUANTUM Gennaker (colour selection) | 13.590 € |
| XE3110 | Squeezer for gennaker | 2.690 € |
| XE9002 | HARKEN Y-track for main sail (not with XE1001, XE1071) | 14.890 € |
| XE9003 | Gennaker package incl. halyard, 2 sheets, 2 blocks and 2 padeyes | 3.690 € |
| XE9100 | Spreader lights, LED, 6 up and 6 down | 4.490 € |

NAVIGATION & INSTRUMENTS

| | | |
|--------|--|---------|
| XF4500 | B&G HAL020+ Broadband Radar (only with XW2010) | 3.890 € |
| XF4650 | Thermal vision camera at mast (only with Navigation Package) | 6.390 € |
| XF4701 | B&G forward looking sonar (only with XW2010) | 1.690 € |
| XF5150 | B&G WR10 autopilot remote controller, wireless (only with XW2010 and XF5001) | 790 € |
| XF9001 | NMEA engine information interface for chart plotter | 890 € |

PROPULSION

| | | |
|--------|--|-----------------|
| XG1105 | Engine (Diesel, approx. 230 hp) - shaft drive, 4-blade folding propeller | 20.990 € |
| XG3201 | Sternthruster, 24V, 145 kp, retractable incl. batteries, electric | 17.190 € |
| XG3211 | Add. electronic throttle at helm position on port | 3.390 € |

EQUIPMENT

| | | |
|--------|---|-----------------|
| XH1001 | Battery set, capacity: 1x 90 Ah + 8x 225 Ah (900 Ah at 24 V) | 4.490 € |
| XH1005 | Battery set, capacity: 1x 90 Ah + 4x 180 Ah Li-lo (720 Ah at 24 V) | 27.290 € |
| XH1601 | Country Version: US / JPN | 5.790 € |
| XH2101 | Generator 15000i, 12,0 kW / 15,0kVA, incl. maintenance kit | 28.890 € |
| XH2151 | 2nd shore power connection with charger, 100 A (only with XH1001 or XH1005) | 6.090 € |
| XH3001 | Electric toilet with sea water flush - cabin layout D1 and D3 | 1.990 € |
| XH3021 | Electric toilet with sea water flush - cabin layout B1 | 1.790 € |
| XH3031 | Electric toilet with sea water flush - cabin layout B2 - B4 | 3.490 € |
| XH3200 | Freshwater dockside connection in cockpit | 690 € |
| XH4100 | Heating, hot water ring with blowers in each cabin and head | 17.290 € |
| XH4511 | Air conditioning, 60.000 BTU, 7 units: 2 saloon, fwd cabin, 2 guest cabin, pantry, aft cabin, incl. 2nd shore power | 46.190 € |
| XH4512 | Air conditioning, 72.000 BTU, 7 units: 2 saloon, fwd cabin, 2 guest cabin, pantry, aft cabin, incl. 2nd shore power | 52.490 € |
| XH5020 | Water maker, 230 V, 200 l / h (only with XH2101) | 25.690 € |
| XH5101 | Additional fridge in cockpit wetbar | 2.190 € |
| XH5110 | Additional fridge in saloon (only with XH1001 or XH1005) | 2.090 € |
| XH5111 | Additional freezer in galley (only with XH1001 or XH1005) | 2.190 € |
| XH5112 | Wine cooler in saloon | 2.690 € |
| XH5120 | Additional freezer in utility room (only with XH1001 or XH1005) | 2.190 € |
| XH5130 | Ice maker in saloon | 2.290 € |
| XH5140 | BBQ in wetbar | 1.690 € |
| XH5150 | Microwave in galley | 1.790 € |
| XH5160 | Coffeemachine in saloon | 890 € |
| XH5161 | BOSCH coffeemachine in saloon | 2.890 € |
| XH5210 | Dishwasher in galley (only with XH2101) | 2.990 € |
| XH5311 | Washing machine with dryer function in utility room (only with XH2101) | 3.490 € |
| XH5409 | Gas leak detector | 990 € |
| XH5412 | Steam cooker in galley | 2.890 € |
| XH6001 | Grey water system for bathrooms and galley, 2 tanks: 370 l | 5.790 € |

RADIO & ENTERTAINMENT

| | | |
|--------|---|----------------|
| XK5000 | VHF preparation with antenna and splitter for FM and AIS | 490 € |
| XK5010 | All-In-One antenna at mast top (VHF, FM radio, TV- analog and DVBT) | 2.190 € |
| XK5011 | Antenna for 3/4G internet and wi-fi onboard | 1.390 € |

ACCESSORIES

| | | |
|--------|---|----------------|
| XV9090 | Ventian blinds for hull windows in saloon and master cabin (colour selection) | 4.890 € |
| XV9120 | Cockpit table cover (colour selection) | 890 € |
| XV9130 | Covers for steering wheels (colour selection) | 590 € |
| XV9380 | Shrink wrap foil (for storage purpose only / not for transport) (not with XA1002, XA1003, XE2051, XE2052, XE2053) | 3.290 € |

SHIPPING & TRANSPORT

| | | |
|--------|------------------------------------|-----------------|
| XZ3001 | Rigging and delivery in Greifswald | 21.790 € |
|--------|------------------------------------|-----------------|

All mentioned prices in €, basic prices ex yard and excl. VAT. All weights and measures are calculated numbers based on the construction data. Changes in construction and equipment reserved. Above mentioned prices are recommended for ex yard deliveries within 4 month after order confirmation. For later delivery time the company reserves right to apply latest price list. Company reserves additional 15 working days when painted hull or deck is ordered. All measurements/figures are approximate. Errors and omissions excepted. Specification and material can be changed without notice. Valid from 2022.03.29.