

SPECIFICATION & PRICELIST

Dehler  **46 SQ**



TECHNICAL DATA

LOA	14.94 m / 49' 0"
HULL LENGTH	13.95 m / 45' 9"
LWL	12.90 m / 42' 4"
BEAM	4.35 m / 14' 3"

DRAUGHT	
standard	2.25 m / 7' 5"
competition	2.58 m / 8' 6"
L-keel deep	2.48 m / 8' 2"
shallow keel	1.85 m / 7' 1"

BALLAST	
standard	3.50 t / 7,716 lbs
competition	3.15 t / 6,944 lbs
L-keel deep	3.35 t / 7,385 lbs
shallow keel	3.85 t / 8,488 lbs

DISPLACEMENT	
standard	11.50 t / 25,353 lbs
competition	11.20 t / 24,691 lbs
L-keel deep	11.40 t / 25,132 lbs
shallow keel	11.90 t / 26,235 lbs

ENGINE APPROX.	Diesel 57 PS / hp
-----------------------	-------------------

FRESH WATER	approx. 450 l / 119.00 gal
--------------------	----------------------------

FUEL TANK	approx. 210 l / 55.00 gal
------------------	---------------------------

MAST ABOVE WL	
standard	21.23 m / 69' 8"
competition	22.20 m / 72' 1"

TOTAL SAIL AREA	
standard	116.73 m ² / 1,256 sq ft
competition	126.79 m ² / 1,365 sq ft

MAIN SAIL	
standard	64.10 m ² / 690 sq ft
competition	70.52 m ² / 759 sq ft

FURLING JIB 105%	
standard	52.63 m ² / 567 sq ft
competition	56.27 m ² / 606 sq ft

SPINNAKER	
competition	150.00 m ² / 1,615 sq ft

GENNAKER	
standard	185.38 m ² / 1,995 sq ft
competition	214.00 m ² / 2,303 sq ft

FREERIDE	
standard	120.38 m ² / 1,296 sq ft
competition	128.50 m ² / 1,383 sq ft

RIG	
standard	I 18.10 m / 59' 5" J 5.50 m / 18' 1" P 17.68 m / 58' 0" E 6.25 m / 20' 6"
competition	I 18.90 m / 62' 0" J 5.50 m / 18' 1" P 18.70 m / 61' 4" E 6.55 m / 21' 6"

CE CERTIFICATE	Class A
-----------------------	---------

DESIGN	judel/vrolijk & co.
---------------	---------------------

INTERIOR	Dehler
-----------------	--------

All measurements/figures are approximate. Errors and omissions excepted. Specification and material can be changed without notice. Valid from 2022.04.13.

DECK AND INTERIOR LAYOUTS

Dehler  **46 SQ**

DECK LAYOUT

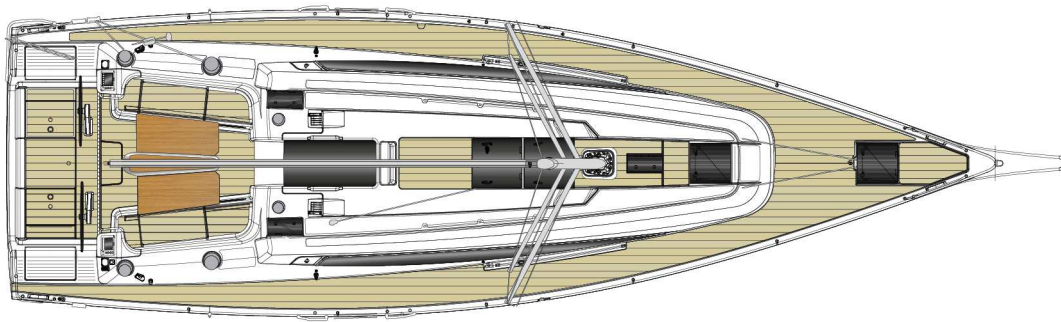

INTERIOR LAYOUT

STANDARD

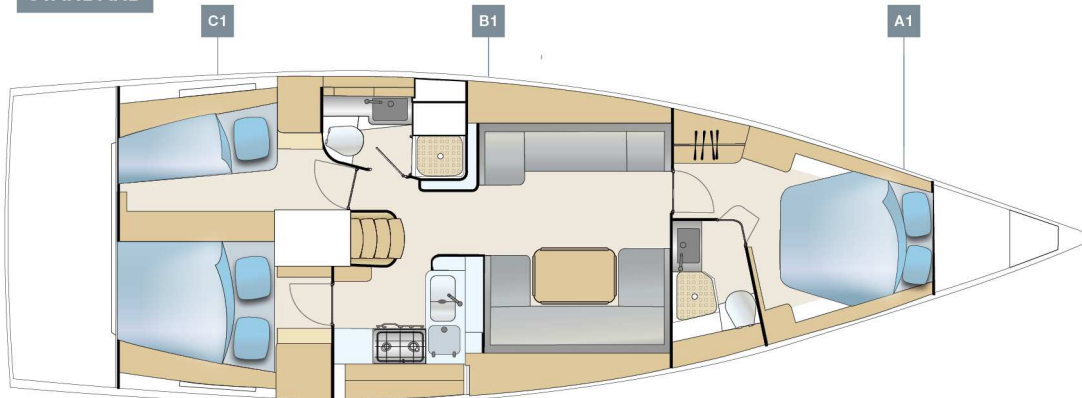

OPTION

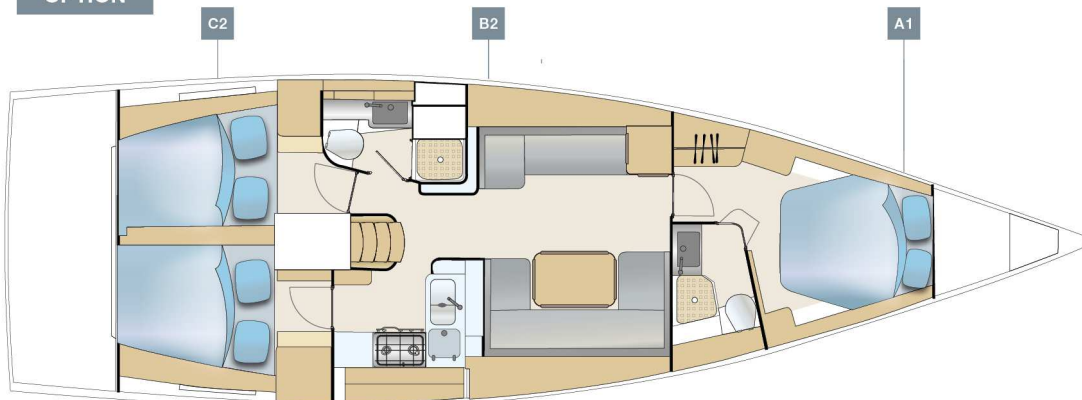

DECK AND INTERIOR LAYOUTS

Dehler  **46 SQ**

INTERIOR LAYOUT

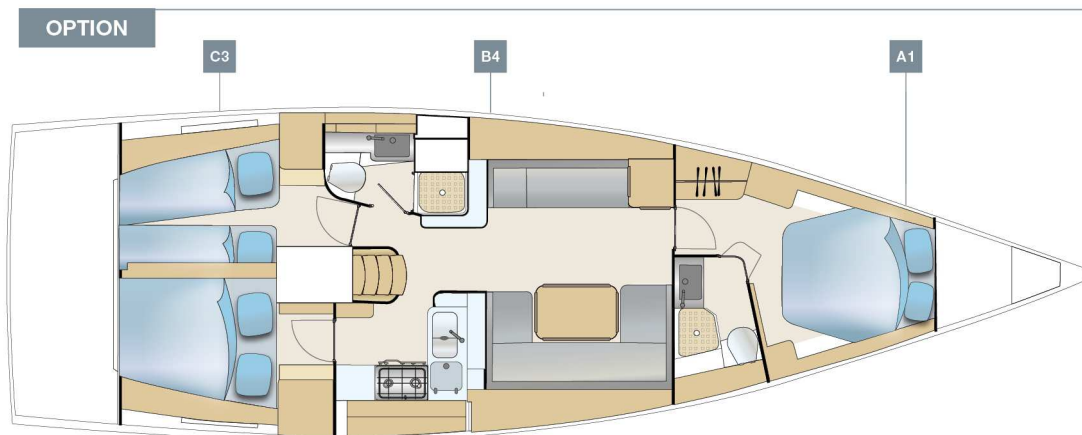
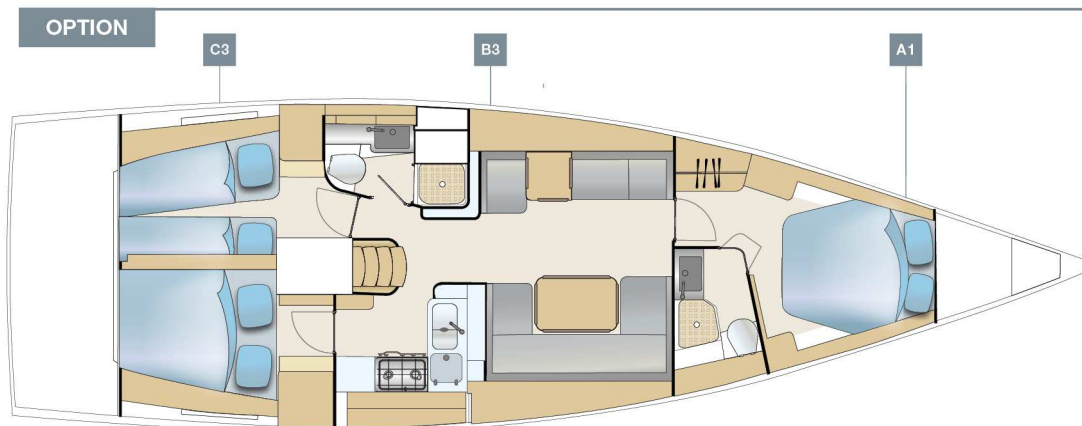

HULL

- 6 hull windows (3 each side)
- GRP hull, isophthalic gelcoat, colour: Signal White (RAL 9003), 1st layer vinylester resin with PVC foam core built in vacuum infusion
- Waterline and cove line, isophthalic gelcoat, colour: Dark Blue (RAL 5004)

KEEL

- L-keel, cast iron, draft: 2.25 m
- GRP rudder with sea-water resistant aluminium shaft and selfaligning bearings

LAYOUT & INTERIOR

- A1: Master cabin with island double berth, storage space and a head with separate shower stall
- B1: Saloon with L-galley, dining area on stb, long sofa and head with separate shower stall on port
- C1: 2 aft cabins: single berth with locker and storage on port and double berth with locker and storage on stb
- 3-burner gas stove, waste bin, 12 V fridge approx. 130 l, double stainless steel sink with mixing tab
- Interior furniture in high quality marine plywood, satin varnish
- Dehler companionway closing system
- Saloon table, folding with stowage
- Worktop in galley, Off White
- Indirect lights in saloon
- SLS - Scenario light system - touch screen controller and dimmer in saloon and master cabin

WOOD (FURNITURE, FLOORBOARD)

- Furniture - Mahogany
- Floorboard - Australian Acacia

UPHOLSTERY

- Mattresses for all berths
- Upholstery - Baltic, colour: creme
- Upholstery - Piping (colour selection)

DECK & OUTSIDE EQUIPMENT

- GRP deck with antislip surface, isophthalic gelcoat, colour: Signal White (RAL 9003), 1st layer vinyl ester resin with balsa sandwich core.
- Cockpit lockers, stern lockers on port and stb, anchor locker at bow.
- Cockpit bottom, gelcoat colour: Signal White (RAL 9003)
- Teak on coach roof
- Teak on cockpit benches
- Twin wheel steering system with emergency tiller
- 2 stainless steel steering wheels with leather cover
- Pulpit and pushpit, stainless steel
- Railing, incl. stanchions and stainless steel wire
- Halyards and control lines with organizers and jammers on coach roof, 4 retractable mooring cleats, handrails on coach roof
- 2 LEWMAR 50 Race manual halyard winches
- 2 LEWMAR 50 Race manual secondary winches
- 2 LEWMAR 50 Race manual mainsheet winches
- Swimming ladder

- Rub rail, aluminium
- LED backlighting design part on the coach roof
- Helmsman footrests, foldable
- Anchor windlass, electrical with automatic fuse
- Composite bowsprit with integrated anchor fitting
- Genoa tracks, incl. cars, adjustable from cockpit
- German mainsheet system with adjustable traveller
- 6 deck hatches - openable, anchor locker hatch
- 8 deck coach roof windows - openable, portlights in cockpit sides for aft cabins

RIG & SAILS

- Rig, anodized aluminium, keel stepped incl.: dyform rigging, running rigging, kicker, manual jib flat deck furler, "Dehler Quick Reefing System", hydraulic backstay tensioner
- QUANTUM AC5 performance sails - full battened, triradial, main and jib
- Dyneema halyards for main and jib

NAVIGATION & INSTRUMENTS

- 2 illuminated compasses at steering pedestal
- Navigation lights - LED

PROPULSION

- Fuel tank, approx. 210 l
- Engine (Diesel, approx. 57 hp) - saildrive, 3 blade folding propeller

EQUIPMENT

- 12 V and 230 V electric system with main panel, 12 V and 230 V socket and 230 V shore power
- AGM battery set - capacity: Starter battery: 1 x 90 Ah, service battery: 1 x 160 Ah
- Country Version: EU / AUS
- Battery charger 35 A
- Manual toilet with sea water flush - cabin layout B
- Manual toilet with sea water flush - cabin layout A
- Shower unit in cockpit, warm-/coldwater
- LPG gas system, stowage for 1 bottle
- Manual and electric bilge pump
- Black water system (appr. 85 l) with deck extraction and seacock for aft head, appr. 35 l in fwd head
- Fresh water system with electric pump and 20 l hotwater, heated also by main engine
- Fresh water tank, appr. 450 l

SHIPPING & TRANSPORT

- CE - Certificate cat. A
- Owners manual
- EC - Type Examination Certificate

AS PER STANDARD SPECIFICATION

excl. VAT
384.900 €

PACKAGES

XW2010	B&G Navigation Package - Cruising	14.390 €
XF2005	Instrument pod on helm station stb	
XF2210	2 B&G Triton ² multifunction displays, 1 per helm station, incl. transducer (wind/depth/speed/temperature)	
XF3000	B&G VHF V60 at chart table, incl. wireless remote handset H60 (only with XK5000)	
XF4040	B&G Zeus ^S 9" chart plotter, stb helm station	
XF5000	B&G Autopilot with Triton ² control unit with WR10 remote control and Precision 9 compass	
XK5000	VHF preparation with antenna and splitter for FM and AIS	
XW2011	Upgrade - Competition	6.290 €
XF2211	2 B&G H5000 multifunction displays, 1 per helm station, incl. transducer (depth/speed/temperature) and wind sensor at vertical carbon mast unit	
XF5001	B&G Autopilot with H5000 control unit with WR10 remote control and Precision 9 compass	
XF5200	B&G CPU Hydra computer (only with B&G H5000 instrument)	
XW2012	Upgrade - second chart plotter	3.090 €
XF2010	Instrument pod on helm station ps	
XF4041	B&G Zeus ^S 9" chart plotter, ps helm station	
XW2013	Upgrade - mast display	4.090 €
XF2240	B&G Nemesis 9" multifunction display at mast	
XW3000	Cruising Package	12.490 €
XC1325	Teak on cockpit bottom	
XC1350	Teak on bathing platform	
XC6001	Bathing platform, manual fold-out with swimming ladder	
XC9032	Courtesy lights in cockpit	
XC9070	Halyard bags	
XC9080	2 add. cleats, midship, retractable (1 each side)	
XC9100	Delta-anchor 20 kg, galvanized with 60 m galvanized chain	
XC9300	2 vents for coach roof hatches	
XF4550	MyDehler Safety Cloud with 24 months subscription and device installed on board	
XH1001	Battery set, capacity: 1x 90 Ah + 2x 160 Ah AGM	
XH1110	Deep charge protection for service batteries	
XV9010	Blind set with flyscreens for hatches	
XV9060	Blinds for hull windows	
XV9080	Blinds for side coach roof windows	
XV9420	Wind indicator	
XV9450	Flagpole	
XV9901	6 fenders	
XV9902	4 mooring lines	
XV9950	Dehler maintenance kit	

XW3001	Upgrade - Flexiteek (colour selection)	1.090 €
XC1311	Flexiteek on coach roof	
XC1326	Flexiteek on cockpit bottom	
XC1341	Flexiteek on cockpit benches	
XC1351	Flexiteek on bathing platform	
XW3002	Upgrade - stainless steel anchor with chain	4.590 €
XC9101	Delta-anchor 20 kg, stainless steel, with 'Ultra' swivel and 100 m stainless steel chain	
XW3003	Upgrade - Battery set Lithium-Ion	8.690 €
XH1005	Battery set, capacity: 1x 90 Ah + 6x 105 Ah Li-ion batteries	
XW3004	Upgrade - MyDehler Safety Cloud extention	3.890 €
XF4655	Interior camera	
XH5409	Gas leak detector	
XK5031	WLAN router incl. booster antenna	
XL9005	Light in navigation area, switchable by APP	
XW3005	Upgrade - automatic fold-out for bathing platform	3.490 €
XC6005	Automatic fold-out for bathing platform with remote control	
XW4000	Competition Package	6.990 €
XA3004	Cove line - Competition	
XB9101	Rudder - Competition	
XC5104	2 LEWMAR 50 Race Plus manual halyard winches	
XC5204	2 LEWMAR 55 Race Plus manual secondary winches	
XC5304	2 LEWMAR 55 Race Plus manual mainsheet winches	
XC9280	Jib barber hauler with low-friction ring	
XW4001	Upgrade - electric halyard winch	3.690 €
XC5103	2 LEWMAR 50 Race halyard winches, port: manual - stb: electric with automatic fuse (only with XH1001 or XH1005)	
XW4002	Upgrade - Competition Keel	12.890 €
XB1002	T-keel, cast iron/lead, (competition) draft: 2.58 m	
XW4003	Upgrade - Side deck - colour	1.790 €
XC1111	Side decks, gelcoat colour: White Grey (RAL 7047)	
XW4004	Upgrade - Cockpit bottom - colour	1.190 €
XC1116	Cockpit bottom, gelcoat colour: White Grey (RAL 7047)	
XW6000	Gennaker Package	7.390 €
XE3105	QUANTUM Gennaker (colour selection - only with XE1000)	
XE3110	Squeezer for Gennaker	
XE9003	Gennaker/Freeride package incl. 2:1 halyard, 2 sheets, 2 blocks and padeyes	

XW6001	Upgrade - Competition Gennaker	1.590 €
XE3107	QUANTUM Gennaker (Competition) (colour selection - only with XE1002)	

XW7000	Entertainment Package	1.990 €
XK1000	FUSION MS-RA70N Multimedia radio with bluetooth - for saloon and cockpit (only with XK5000)	
XK2000	2x 2 high-end speakers in saloon and cockpit	
XK3000	FUSION MS-NRX remote control in cockpit	

XW7001	Upgrade - premium radio	790 €
XK1001	FUSION APOLLO MS-RA770 Multimedia radio with Wi-Fi and touchscreen - for saloon and cockpit (only with XK5000)	
XK3001	FUSION MS-ERX400 remote control in cockpit	

XW7010	Entertainment Package - Master cabin	3.290 €
XK1010	FUSION APOLLO MS-RA770 Multimedia radio with Wi-Fi and touchscreen - for master cabin (only with XK5000)	
XK2010	2 high-end speakers in master cabin	
XK4010	TV preparation in master cabin	
XK4110	LED TV flat screen in master cabin	

XW7030	TV Package	4.490 €
XK4040	TV preparation in saloon	
XK4140	LED TV flat screen in saloon	
XK4240	TV lifting system in saloon	
XK5020	DVB-T2 antenna for TV	

OPTIONS

excl. VAT

HULL

XA1001	GRP hull, gelcoat colour: Grey (RAL 7040)	5.290 €
XA1002	GRP hull, painted, non metallic (colour selection)	23.090 €
XA1003	GRP hull, painted, metallic (colour selection)	30.390 €
XA3001	Waterline and cove line, coloured gelcoat (colour selection - not with XA1002 or XA1003)	890 €
XA3002	Waterline and cove line, painted, non metallic (colour selection - only with XA1002 or XA1003)	990 €
XA3003	Waterline and cove line, painted, metallic (colour selection - only with XA1002 or XA1003)	1.190 €

KEEL

XB1001	L-keel, cast iron, draft: 1.85 m	5.290 €
XB1002	T-keel, cast iron/lead, (competition) draft: 2.58 m	15.390 €
XB1003	L-keel, cast iron/lead, draft: 2.48 m	14.590 €
XB9000	Keel and rudder - not mounted	1.090 €
XB9101	Rudder - Competition	1.790 €

LAYOUT & INTERIOR

XL2002	B2: Saloon with L-galley, dining area on stb, sofa with chart table at the main bulkhead and head with separate shower stall on port	1.190 €
XL2003	B3: Saloon with L-galley, dining area on stb, sofa with chart table and head with separate shower stall on port	2.290 €

XL2004	B4: Saloon with L-galley, dining area on stb, storage and sofa with chart table at the main bulkhead and head with separate shower stall on port	2.990 €
XL3002	C2: 2 aft cabins with double berth, locker and storage	2.190 €
XL3003	C3: 2 aft cabins: scissor berth, locker and storage on port and double berth, locker and storage on stb	2.990 €
XL7002	Saloon table with cushion, lowerable and convertible into double berth	2.890 €
XL7221	Bench in saloon on port, electric driven (not with XL2003 and XL7002)	3.490 €
XL7601	Worktop in galley - Black	890 €
XL7602	Worktop in galley - Dark Grey	890 €

WOOD (FURNITURE, FLOORBOARD)

XM1101	Furniture - Teak	7.390 €
XM1103	Furniture - Oak	7.390 €
XM1201	Floorboard - Noce Nero	1.090 €
XM1202	Floorboard - Classic Stripes	2.090 €
XM1203	Floorboard - Piave Oak	1.090 €
XM9000	Floorboard - Wood style flooring in all showers	790 €

UPHOLSTERY

XN1100	Deluxe mattresses for all berths	3.390 €
XN2001	Upholstery - Arctic (colour selection)	1.290 €
XN2002	Upholstery - Pacific (colour selection)	2.090 €
XN2003	Upholstery - Biscay (colour selection)	2.890 €
XN2004	Upholstery - Adriatic Leather (colour selection)	4.790 €
XN2400	Sun bed cushions on coach roof (colour selection)	2.090 €
XN2500	Cockpit cushions (colour selection)	2.690 €

DECK & OUTSIDE EQUIPMENT

XC1300	Teak on side decks	17.290 €
XC1301	Flexiteek on side decks (colour selection)	18.390 €
XC2201	2 GRP steering wheels, Y-spoke (black or white)	1.790 €
XC3001	Fixed cockpit table, stainless steel with folding teak tops and retractable LED light	1.890 €
XC3004	Removable cockpit table, stainless steel with foldable teak tops	1.890 €
XC3030	Instrument pod on coach roof (not with XE2012)	990 €
XC4001	Gateway stanchion	990 €
XC4002	Railing, stainless steel wire, competition performance	1.190 €
XC5103	2 LEWMAR 50 Race halyard winches, port: manual - stb: electric with automatic fuse (only with XH1001 or XH1005)	4.190 €
XC5201	2 LEWMAR 55 Race manual secondary winches	2.690 €
XC5301	2 LEWMAR 55 Race manual mainsheet winches	2.690 €
XC5302	2 LEWMAR 50 Race electrical mainsheet winches with automatic fuse (only with XH1001 or XH1005)	7.890 €
XC6501	Gangway, carbon, foldable with bag, 220 cm	2.990 €
XC6602	Bow ladder for easy access on the bow	1.090 €
XC9021	Rub rail, stainless steel	2.090 €
XC9070	Halyard bags	590 €
XC9210	Self tacking jib system (not with XE1002)	2.590 €

XC9261	GRP arch for cockpit - white, for mainsheet, instead of the traveller	13.790 €
XC9280	Jib barber hauler with low-friction ring	790 €

RIG & SAILS

XE1002	Mast (Competition), carbon with rod rigging and black alu boom for pin top mainsail with flat deck furler	52.990 €
XE2001	Maindrop system with lazy jacks (colour selection)	1.490 €
XE2012	Sprayhood with stainless steel stake, 3 windows (1 openable) (colour selection)	3.390 €
XE3010	QUANTUM TP6 high-performance sails - full battened, UV-protected membrane, main and jib	12.890 €
XE3021	QUANTUM AC5 performance sail - full battened, triradial, self tacking jib (only with XC9210)	5.990 €
XE3022	QUANTUM TP6 high performance sail - full battened, UV-protected membrane, self tacking jib (only with XC9210)	10.790 €
XE3300	QUANTUM Freeride sail - with CX endless furler and storage bag (only with XE1000)	7.190 €
XE3302	QUANTUM Freeride sail (Competition) - with CX endless furler and storage bag (only with XE1002)	8.090 €
XE3310	QUANTUM AC5 performance sail - triradial, staysail with 2:1 halyard, CX endless furler and sheets	7.190 €
XE3311	QUANTUM TP6 high performance sail - UV-protected membrane, staysail with 2:1 halyard, CX endless furler and sheets	11.790 €
XE4003	Spinnaker package incl. carbon pole, halyard, 2 sheets, 2 blocks and padeyes	5.990 €
XE9003	Gennaker/Freeride package incl. 2:1 halyard, 2 sheets, 2 blocks and padeyes	2.190 €

NAVIGATION & INSTRUMENTS

XF2223	2 B&G Triton ² multifunction displays at companionway (only with XC3030)	1.390 €
XF2224	2 B&G H5000 multifunction displays at companionway (only with XC3030 and XW2011)	1.890 €
XF4000	B&G Zeus ³ 7" chart plotter at chart table	2.490 €
XF4500	B&G HALO20+ Broadband Radar (only with chart plotter)	3.890 €
XF4600	B&G AIS Class B transponder (only with navigation package)	1.590 €
XF4650	Thermal vision camera at mast (only with Navigation Package)	6.390 €
XF9001	NMEA Engine information interface (only with chart plotter)	1.290 €

PROPULSION

XG1103	Engine (Diesel, approx. 80 hp) - saildrive, 3 blade folding propeller	5.290 €
XG3101	Bowthruster, 12 V, retractable, incl. battery	10.490 €

EQUIPMENT

XH1601	Country Version: US / JPN	3.490 €
XH2101	Generator, 4.0 kW / 4.5 kVA, incl. maintenance kit	15.690 €
XH2201	Inverter/charger, 12 V / 1600 W - 60 A, incl. larger AC panel (only with XH1001 or XH1005)	2.790 €
XH3001	Electric toilet with sea water flush - cabin layout B	1.690 €
XH3011	Electric toilet with sea water flush - cabin layout A	1.690 €
XH4011	Heating, hot air with up to 6 blowers (not with XH4511)	6.790 €
XH4511	Air conditioning, 28.000 BTU, 3 units: fwd cabin, saloon and aft cabin (incl. 2nd shore power plug) (not with XH4011)	17.790 €
XH5100	Add. fridge in galley (not with XH5210)	1.690 €
XH5112	Wine cooler in saloon (only with XL2004)	2.190 €
XH5150	Microwave in galley	1.790 €
XH5160	Coffee machine in galley	990 €

PRICELIST



XH5210	Dish washer in galley (not with XH5100)	1.990 €
XH6001	Grey water system for bathrooms and galley, tank: 70 l	3.390 €

RADIO & ENTERTAINMENT

XK5000	VHF preparation with antenna and splitter for FM and AIS	490 €
XK5011	Antenna for 3G/4G internet and Wi-Fi onboard	1.390 €

ACCESSORIES

XV9120	Cockpit table cover (colour selection)	590 €
XV9130	Cover for steering wheels (colour selection)	590 €
XV9380	Shrink wrap foil (for storage purpose only / not for transport) (not with XA1002 or XA1003)	890 €
XV9960	Electronic safe in forward cabin	1.290 €

SHIPPING & TRANSPORT

XZ2001	Loading on truck	590 €
XZ2003	Oversea shipping pack (cradle)	3.490 €
XZ2020	Ready for pickup	690 €

All mentioned prices in €, basic prices ex yard and excl. VAT. All weights and measures are calculated numbers based on the construction data. Changes in construction and equipment reserved. Above mentioned prices are recommended for ex yard deliveries within 4 month after order confirmation. For later delivery time the company reserves right to apply latest price list. Company reserves additional 15 working days when painted hull or deck is ordered. All measurements/figures are approximate. Errors and omissions excepted. Specification and material can be changed without notice. Valid from 2022.04.13.